

CHASING Docking Station

User Manual

V1.0

This multi-interface docking station is an exclusive advanced accessory custom-developed for CHASING underwater ROV, with a total of seven interfaces. It can be used for expansion of the AC power supply system, mountable auxiliary cameras, laser ruler, multi-beam sonar, USBL positioning system, floodlight and other advanced accessories to meet the needs of ROV to mount and use multiple accessories at the same time.

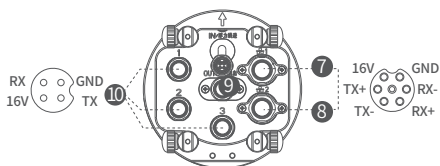
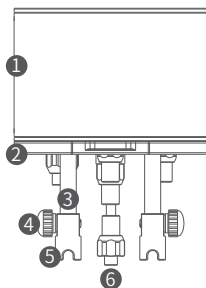

1. Control enclosure
2. Mounting seat
3. Mounting feet
4. Thumb screw
5. Mounting support
6. Docking station-ROV cable
7. Multibeam sonar interface
8. Auxiliary camera interface
9. Tether socket / AC power tether socket
10. General interface(Floodlight/USBL/Laser ruler)

Installation and connection

- 1) Unscrew the thumb screws, remove the mounting support from the docking station, then screw it to the support rod on the top of the ROV with four M3*8 screws.

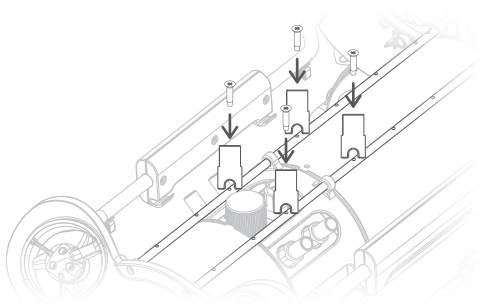
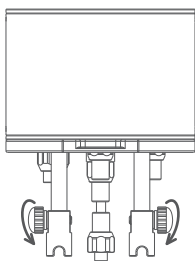

2. Connect and tighten the “docking station-ROV” cable, remove the other connector plugs from the docking station as needed, then connect the required accessory connection cable correctly to the corresponding connector of the docking station and tighten it.

3. ①Insert the mounting feet of the docking station into the mounting support, ②then tighten the thumb screws to complete the installation.

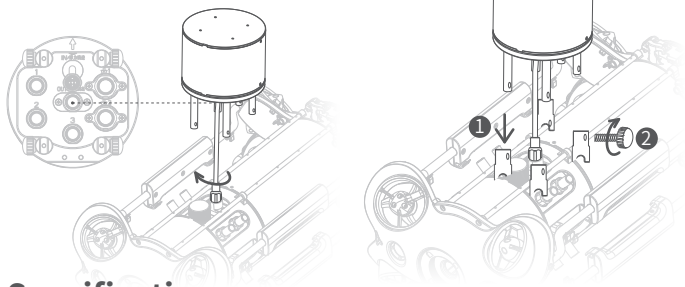

Specifications

Size	120*157mm
Weight	≈1050g(in the air)
Power Supply	Output:16V
Interface	UART*3, RJ45*2

Precautions

1. Please be sure to install and connect the docking station after the ROV is powered off.
2. Be sure to connect the accessories properly according to the markings on the docking station, incorrect connections will result in hardware damage.
3. Check and keep both the communication interface and tether interface dry and clean before use. Salt and moisture may cause the corrosion of connector interface. If the interface happen to be wet, please be sure to use fresh water to rinse the socket, use paper towels or cotton balls to absorb the moisture in the socket.
4. Pay attention to check whether the O-ring on the connection cable connector. If it is missing and broken, please replace it in time.
5. For docking station interfaces without accessories attached, please ensure that the connector plug is installed.
6. After use, the mounting support can be left in place on the ROV. By doing so, it will be easier to facilitate the subsequent direct installation of the docking station.

CHASING

www.chasing.com

support@chasing-innovation.com

This content is subject to change without prior notice,

you could have the latest user manual by the
www.chasing.com.